

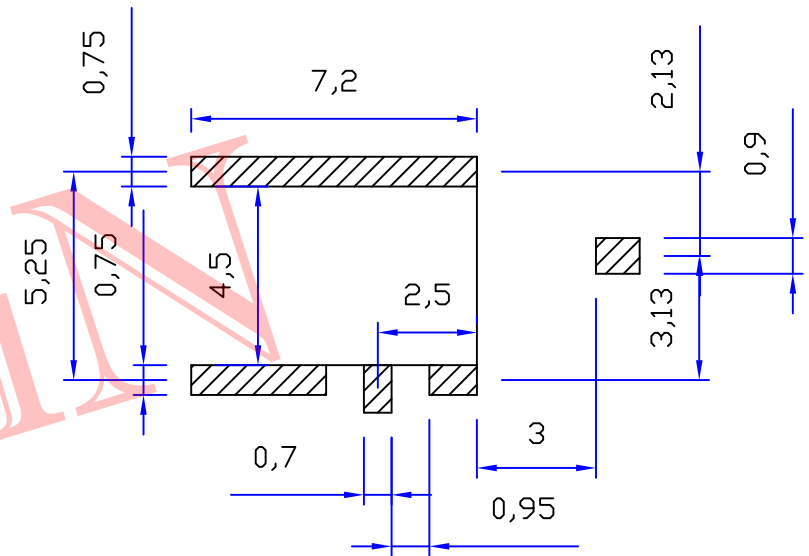

Product NO.		DOSIN-809-0045		
REV	DESCRIPTION	DWN	DATE	APPROVEN
A	First issue	Mr. Wang	2015/12/24	John kine
B				

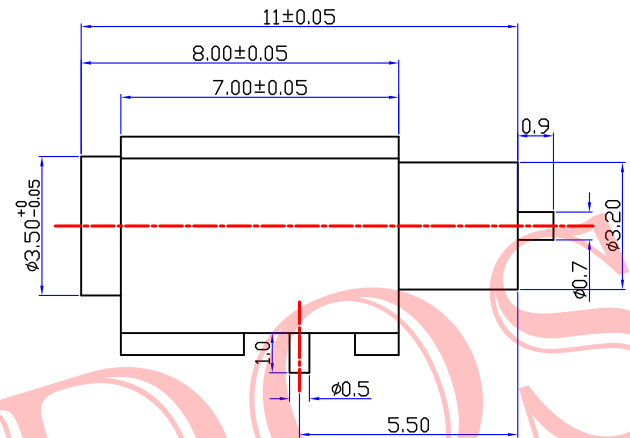
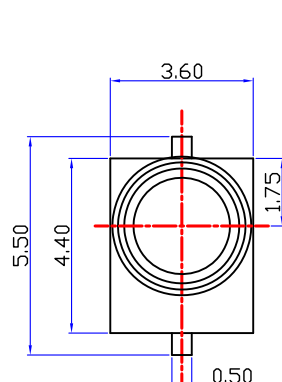

1. Electrical Characteristics
 - 1.1 Impedance: 50 Ohm
 - 1.2 Working Frequency: DC - 3 GHz
 - 1.3 S.W.R. : ≤ 1.5
 - 1.4 Working Voltage: 335V / max
 - 1.5 Insulation Resistance: 1000 Mohm
 - 1.6 Contact Resistance: Center Contact: 5 mohm
 - 1.7 Outer Contact: ≤ 2.5 mohm
2. Environmental
 - 2.1 Working Temperature Range: - 55 ° C ~ +125° C
3. With the male head to turn off, not to plug conduction

RECOMMENDED PCB LAYOUT

NOTE:	Tolerance	X. ±0.15 X.X ±0.10 X.XX ±0.05 Angular ±5°
DRAWN Zelin. Zhang	View	
CHECKED	UNIT	MM
APPROVALS John Kine	SCALE	1:1

Dosin Industrial (HK) Co Ltd 东莞市德索五金电子制品有限公司 Dosin Hardware Electronics Co., Ltd		E-mail: dosin2005@163.com dosin2005@dosin-china.com Web: http://www.dosinconn.com TEL: (0086) 769-81153906 FAX: (0086) 769-81875836	
Name: MCX P. C. B JACK			
SIZE A	Product NO. DOSIN-809-0045	REV A	
DateTime 2015/12/24	CAD FILE H/company drawings/BD	SHEET: 1 OF 1	

1	Body	Brass	Au: lu
2	Insulator	TEFLON	White
3	Center contact	Phosphor	Au: 3u
NO	Component Number	Material	Finish